

ELH EL LED 3h SC RM OFFICE

Item number EN10080029
GTIN 4015120080029

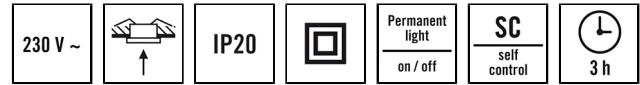

Product description

- Single-battery 3-h emergency light for Recessed ceiling mounting. Optionally, operation in continuous or stand-by mode possible
- Downwards light emission and optimised for illumination of rooms. Test results indicated by coloured LEDs (green/red)
- Self-monitoring and optional controllable remote shutdown, as well as Status readout function via DALI bus



Technical data

GENERAL

Device category	Safety light
User interface	DALI-Bus
Remote controllable	–
Conformity	CE, RoHS, WEEE
Warranty	5 years

ATTACHMENT

Installation type	Recessed mounting
Installation position	Ceiling
Installation dimension	Installation depth: 45 mm, Ø 43 mm
Type of connection	Push terminal
Connectable wire cross section	1,50 - 2,50 mm ²

HOUSING

Dimensions	Height/Depth 45 mm, Ø 55 mm
Weight	441 g
Material	UV-stabilised polycarbonate
Protection type	IP20
Permissible ambient temperature	5 °C...+35 °C
Relative humidity	5 - 95 %, non-condensing

Colour white, similar to RAL 9016

ELECTRICAL VERSION

Protection class	II
Nominal voltage	230 V / 50 Hz
In-rush current	1,4 A / 442 µs
Leakage current	0,019 mA

LIGHT

Light emission	direct
Rated output	4 W
Luminous Flux (light)	155 lm
Luminous efficacy	38 lm/W
Colour temperature	approx. 4500 K
Colour rendering index Ra	> 75
Energy efficiency class	A++ to A

EMERGENCY LIGHTING

Light duration	3 h
Power supply system	Decentralised (single-battery)
Battery status indicator	by LED
Automatic testing	✓

Accessories

Product designation	Item number	GTIN
ELH FM BATTERY 2000mAh	EN00007361	4015120007361

DATA SHEET

ELH EL LED 3h SC RM OFFICE

Item number **GTIN**
EN10080029 4015120080029

Scale drawing

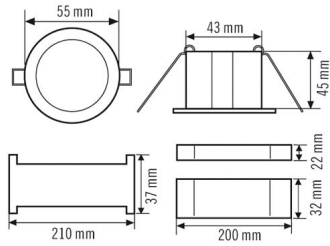

Light distribution

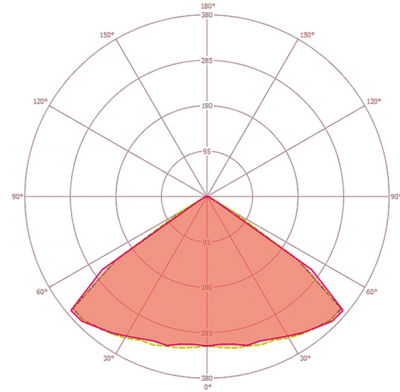

Circuit diagram

