

Ref.: 6610 19/20/21/22/23/24

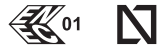

IP 42				6610 19/20/22 (NM)	6610 21 (NM)	6610 23/24 (C)
6610 19 NM	1h	100lm				
6610 20 NM	1h	200lm				
6610 21 NM	1h	250lm				
6610 22 NM	2h	160lm				
6610 23 C	2h	110lm				
6610 24 C	1h	200lm				

6610 19/20/22 (NM) + 6610 40		6610 21 (NM) + 6610 40		6610 23/24 (C) + 6610 40	
---------------------------------	--	---------------------------	--	-----------------------------	--

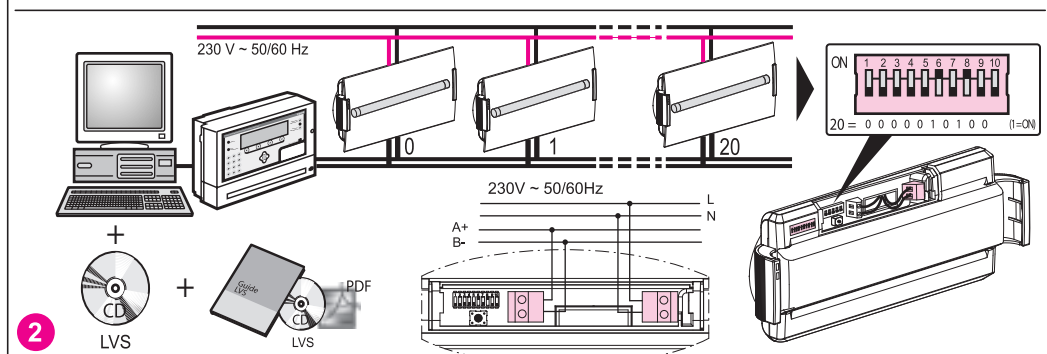
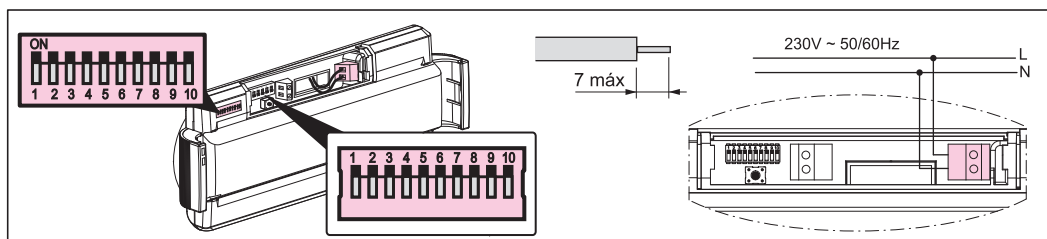
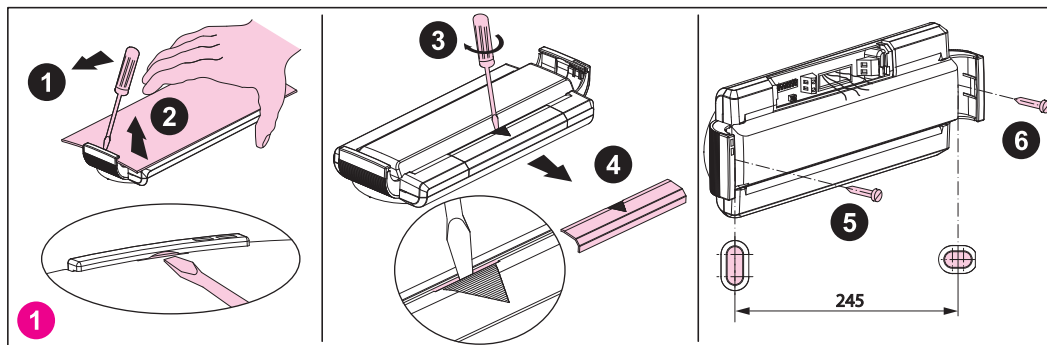

NE49178/01

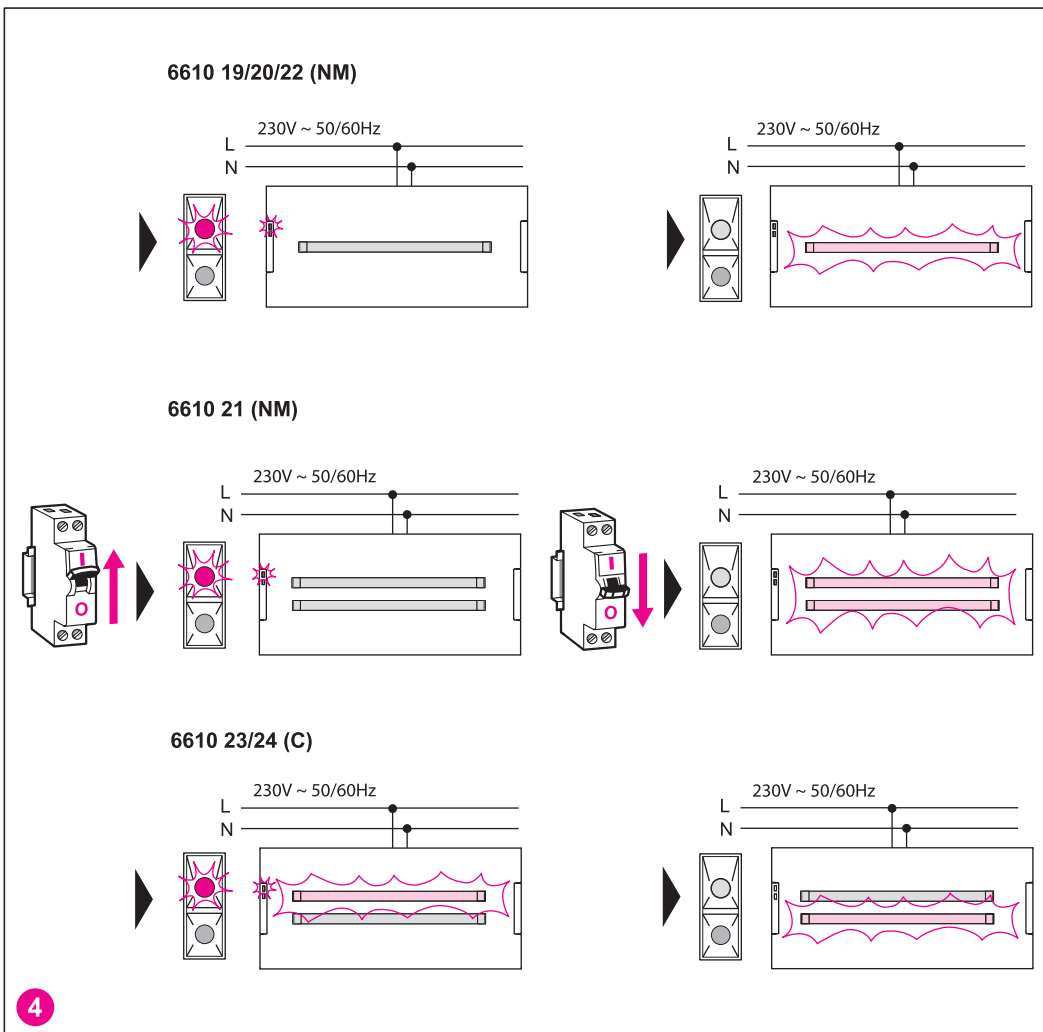
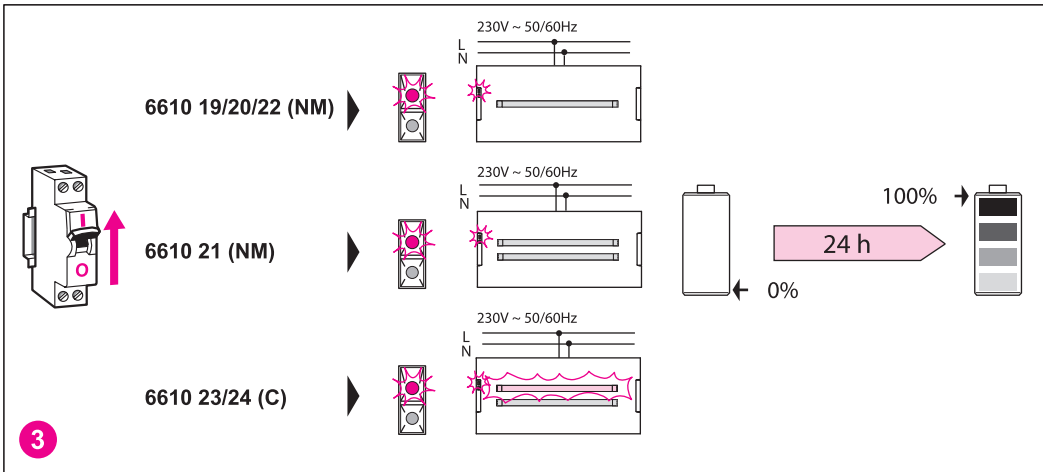

- Test automático semanal
- Teste automático semanal
- Automatisk veckotest
- Automatisk uge test

- Test automatique hebdomadaire
- Programmatie van de testtijdstippen
- Weekly automatic test
- Wöchentlicher automatischer Test

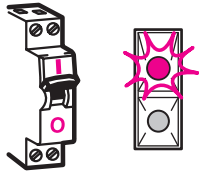
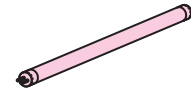

6610 19/20/22 (NM)

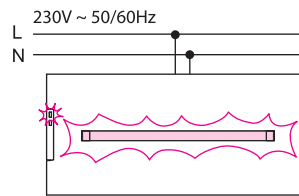
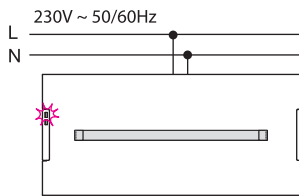

6610 21 (NM)

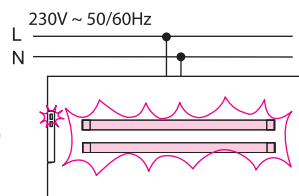
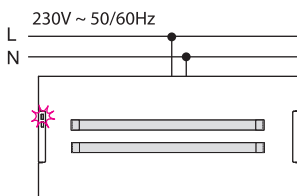

6610 23/24 (C)

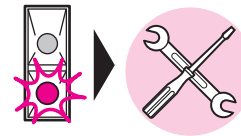
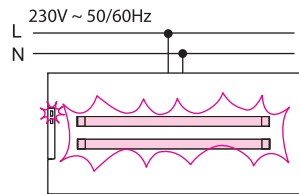
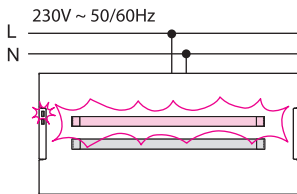

- Test automático trimestral
- Teste automático trimestral
- Automatisk kvartalstest
- Automatisk kvartals test

- Test automatique trimestriel
- Driemaandelijke automatische test
- Quarterly automatic test
- Vierteljährlicher automatischer Test

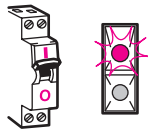
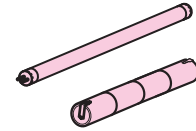

6610 19
6610 20
6610 21
6610 24

2h 6610 22
6610 23

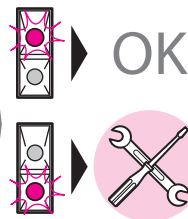
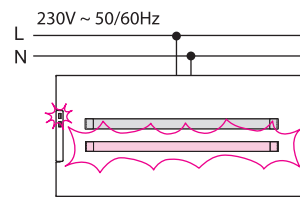
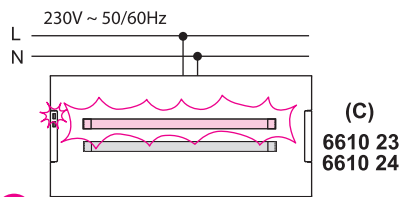
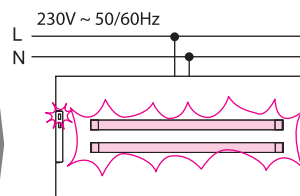
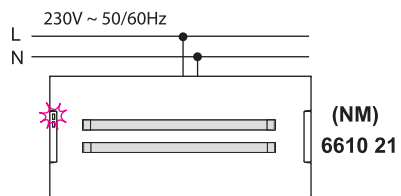
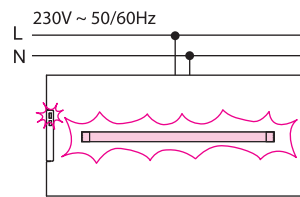
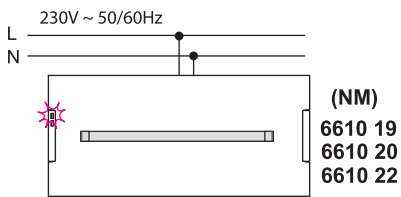

6

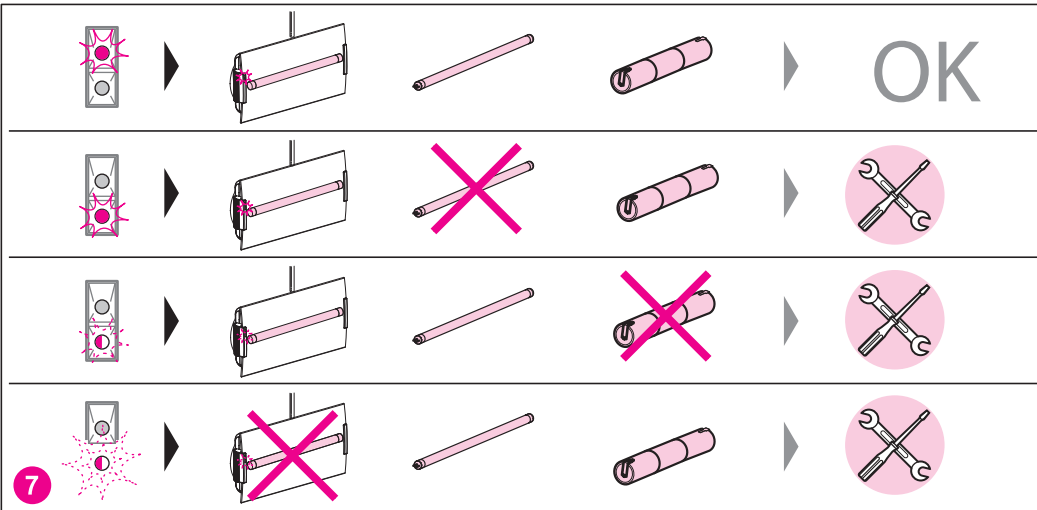

- Programación de las horarios de test
- Programação dos horários de testes
- Programmering av testtimmar
- Planlagte test timer

- Programmation des heures de test
- Programmering van de uren van tests
- Scheduling test hours
- Programmierung des Testzeitpunktes

• Nota : La hora de test de cada emergencia puede ser modificada pulsando 3 segundos como mínimo el botón TEST en la nueva hora deseada.

Importante : este cambio de hora de test dispara en el momento o en las 24 horas siguientes un test trimestral.

• Note : L'heure de test de chaque BAES peut être modifiée par un appui de 3 secondes minimum sur le bouton TEST à la nouvelle heure souhaitée.

Important : ce changement d'heure de test déclenche aussitôt ou dans les 24 heures un test trimestriel.

• Note : Het testtijdstip van elke BAES kan gewijzigd worden door een druk op de TEST-knop van minimum 3 seconden op het nieuwe gewenste tijdstip.

Belangrijk : deze tijdstipwijziging zet onmiddellijk of binnen 24 uur een autonometest in werking.

• Note : The test hour of each self-contained emergency lighting unit can be modified by pressing the TEST button for at least 3 seconds at the new desired hour.

Important : changing the test hour triggers a quarterly test either immediately or within 24 hours.

• Anmerkung : Der Testzeitpunkt jeder Sicherheitsleuchte kann geändert werden, indem man exakt zum Zeitpunkt an dem der neue Test gestartet werden soll, mindestens 3 Sekunden den TEST-Knopf betätigt.

Wichtig : Diese Veränderung des Testzeitpunktes löst sofort oder innerhalb von 24 Stunden einen vierteljährlichen Test aus.

• Nota : A hora de teste de cada bloco autónomo de iluminação de segurança (B.A.I.E.S.) pode ser alterada apoiando no mínimo 3 segundos sobre o botão TEST à nova hora desejada.

Importando : esta mudança de hora de teste desencadeia imediatamente ou nas 24 horas um teste trimestral

• Notera : Tidpunkten för varje självtest kan ändras genom att trycka minst 3 sekunder på testknappen till den önskade tidpunkten.

Viktigt : Vid ändring av testtiden aktiveras en kvartalstest omedelbart eller inom 24 timmar.

• Note : Den indtastede test time for hvert selvforsynende nødbelysningsarmatur kan ændres ved at holde på TEST knappen nede i mindst 3 sekunder hvorefter den ændres til den ønskede time.

Vigtigt : Ændring af test time udløser en kvartalstest enten med det samme eller indenfor 24 timer.

6610 19/20/21/22/23/24

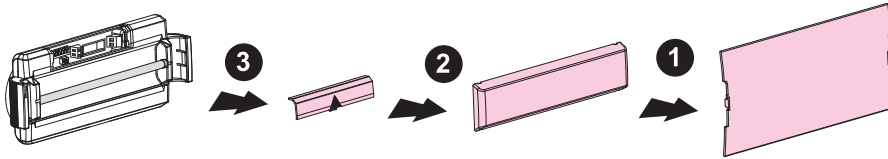

6610 19/20/22 (NM)

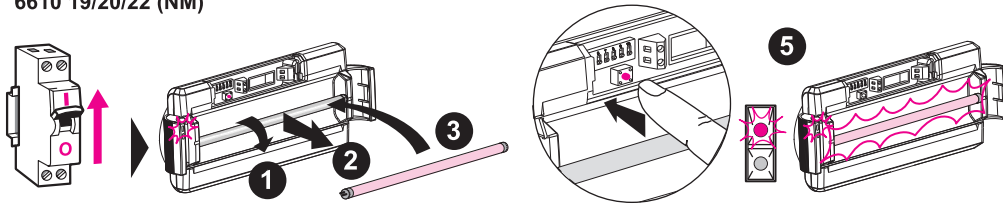

6610 21 (NM)

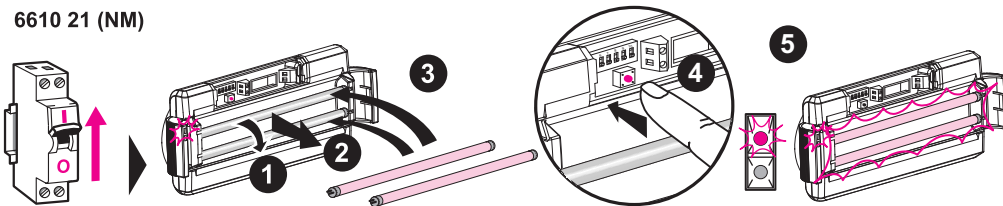

6610 23/24 (C)

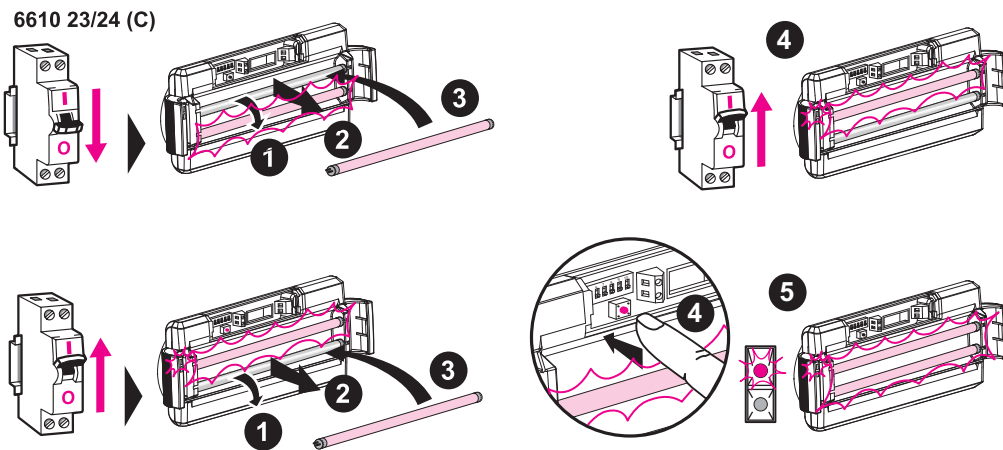

6610 19/20/21/22/23/24

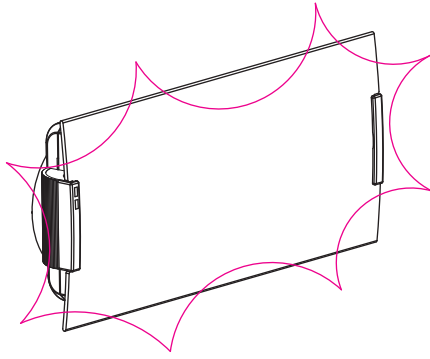

Lm.=100%

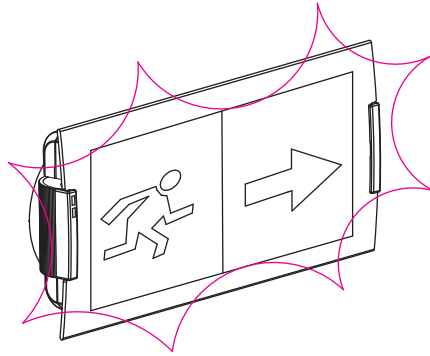

Lm.=50%

