

Technical Data Sheet



13.01.2014

Description:	Busbar Tapping 16mm ²
Construction:	uninsulated
Item no. :	086105-9-2

Remarks:	The product is compliant with the EC ROHS directives
Standards:	-
Nominal Voltage:	690 V
Nominal current:	114 A - (Details see below)

Busbar cross section / Incoming

1 x Busbar	Cu busbar strength (height) 3 – 10 mm / depth (width) minimum 10 mm Clamping screw for busbar connection: cross-head screw M8 x 20 +/- PZ3 tightening torque 3 Nm
------------	----------------------------------------------------------------------------------------------------------------------------------------------------------------------------

Terminal cross section / Outgoing

2 x 16 mm ²	1,5 – 16 mm ² , round conductor Cu (solid wire and multi wire) 1 – 10 mm ² , stranded wire with ferrule cross-head screw M6 x 10 +/- PZ2 tightening torque 2,5 Nm stripping length 9 mm
------------------------	---------------------------------------------------------------------------------------------------------------------------------------------------------------------------------------------------------------------------

Materials:	Terminal body: brass (CuZn39Pb2) bright
	Screws: steel Zn thick-film passivated

Mechanical data:	Dimensions: width x height x depth (mm): 12 x 37 - 42,1 x 32
-------------------------	--------------------------------------------------------------

mounted dimensions (5 mm bar)

mounted dimensions (10 mm bar)

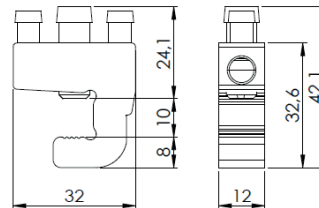
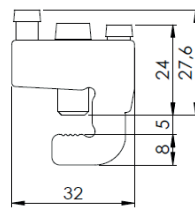

Approved phase rails dimensions / Outgoing

	busbar strength						
	3 mm	4 mm	5 mm		10 mm		
E-Cu, blank (width in mm)	-	12	12, 15, 20, 25, 30, 40, 50, 60, 63, 80, 100, 125		12, 15, 20, 30, 40, 50, 60, 80, 100, 120, 160, 200		
E-Cu, tin-plated (width in mm)	10	-	12, 15, 20, 25, 30		12, 20, 30, 40, 50, 60, 80, 100, 120		
Nominal current	76 A	76 A	114 A	76 A	114 A	76 A	114 A
Outgoings (maximum cross section)	1 x 16 mm ²	1 x 16 mm ²	2 x 10 mm ²	1 x 16 mm ²	2 x 10 mm ²	1 x 16 mm	2 x 10 mm ²

Design

Basic housing colour – light grey RAL 7035

Part no.	Design	Cover colour	PU	GTIN (EAN)
086105-9-2	Universal	-	12	4051589610599