

● Time Delay Switch



**Utilization**

**N.B:** These values to be reduced by 20% per temperature band of 10°C above 25°C.

 25°C 230V 50Hz/60Hz	① 	② 	③  ø26 ø38	④ 	⑤ 	⑥ 	⑦ 	⑧ 
Max	1000W	1000W	— NO —	— NO —	— NO —	— NO —	— NO —	— NO —
Min	25W	25W						

1. Incandescent lamps
2. 230V Halogen lamps
3. Fluorescent lamps ø26mm or ø38mm (forbidden)
4. Halogen lamps with electronic ballast (forbidden)
5. Motors (forbidden)
6. Halogen lamps with ferromagnetic transformer (forbidden)
7. Ferromagnetic transformer (forbidden)
8. Additional radiators (forbidden)

**Important:** If the wiring diagrams are not strictly followed, or if the values shown in the table are exceeded (voltage, power, temperature, frequency), or if the power is too low and causes the light to blink, the switch would be severely damaged.

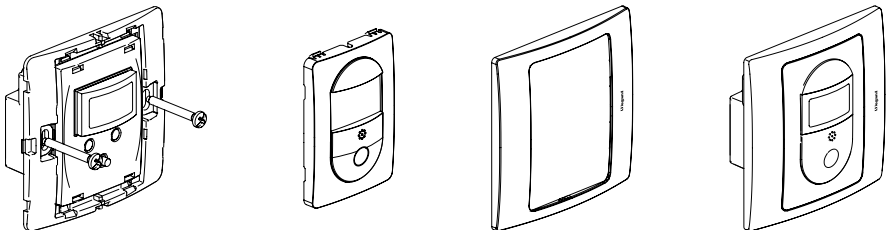

## Wiring

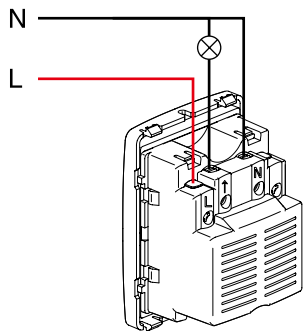

**Important:** If the wiring and installation do not comply with the above instructions, all damages to the product or other devices will be excluded from warranty.

## Pre-setting

- Delay time adjusting range: 5 min to 12 h
- Delay time setting (Removing plate and cover first)

For example:

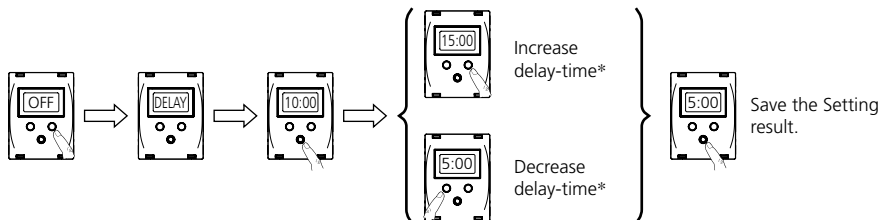

\* Setting delay time: 5min to 1h, increase/decrease 5min by 5min  
1h to 12h, increase/decrease 15min by 15min

## Operation

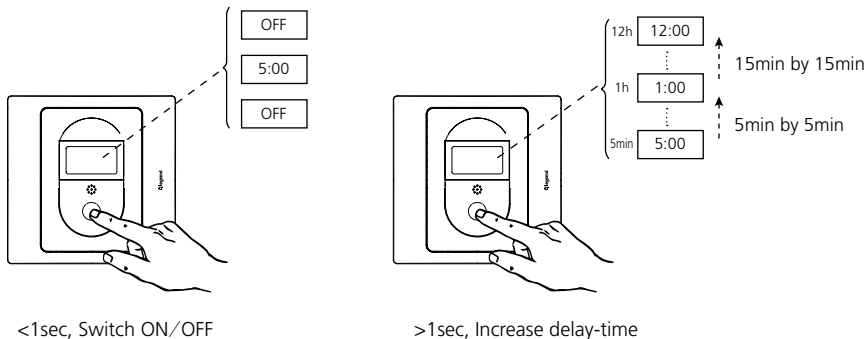

<1sec, Switch ON/OFF

>1sec, Increase delay-time