

Arteor™ RJ 45 double sockets

Catalogue number(s): 5 723 35/36 - 5 728 35/36

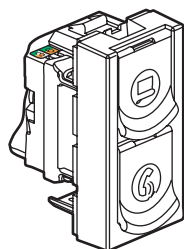

CONTENTS	Page
1. General characteristics	1
2. Presentation	1
3. Use scenarios	1
4. Technical characteristics	1
5. Installation	2
6. Overall dimensions	2
7. Connection	2
8. Standards and approvals	3



1. GENERAL CHARACTERISTICS

The double socket allows two applications to be used at the same time on a single 4-pair cable: phone/data. The ethernet speed is 10/100 Mbit/s.

The double socket wiring device heightens anti-theft security and damage protection and does not harm the RJ 45 socket.

Each port has a dust-protection hood and is totally flush-fitting.

The double socket is used in association with another double socket of the same type (PHONE/DATA) on the patch panel.

Designation	Colour	Nbr. of modules	UTP	FTP	Weight (g)
 Double RJ 45 socket UTP TEL/DATA	White Magnesium	1	5 723 35 5 728 35		18
 Double RJ 45 socket FTP TEL/DATA	White Magnesium	1		5 723 36 5 728 36	18

2. PRESENTATION

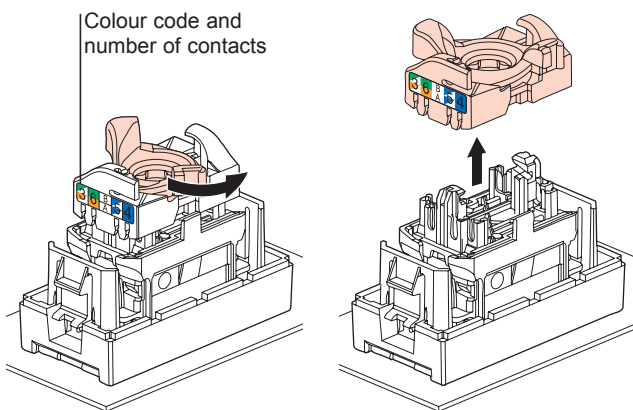

3. USE SCENARIOS

The mechanisms can be flush-mounted or surface-mounted.

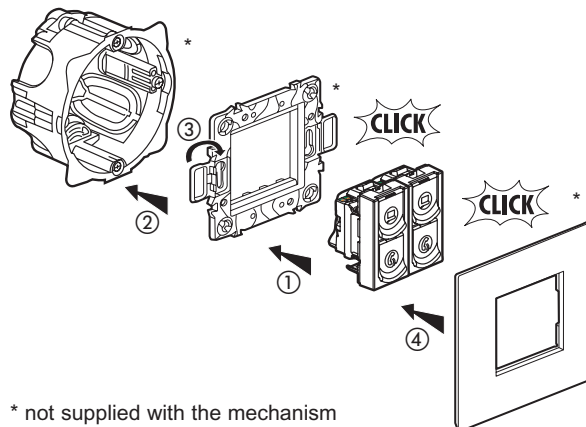

4. TECHNICAL CHARACTERISTICS

4.1 Material characteristics

Contacts: gold/nickel, thickness of gold > 0.8 µm min.
Metal parts: bronze, nickel, platinum, gold
PBT polycarbonate

4.2 Electrical characteristics

Breakdown voltage ≥ 1000 V
Contact resistance ≥ 20 mΩ
Insulation resistance ≥ 500 MΩ at 100 V DC.

4.3 Mechanical characteristics

Max. number of connections and disconnections: 5 without refreshing the cable
Endurance: 2500 movements (plug insertion/withdrawal)
IK03

4.4 Climatic characteristics

Operating temperature: -40°C to +70°C
Humid heat cycle 21 days

Arteor™ RJ 45 double sockets

Catalogue number(s): 5 723 35/36 - 5 728 35/36

5. INSTALLATION

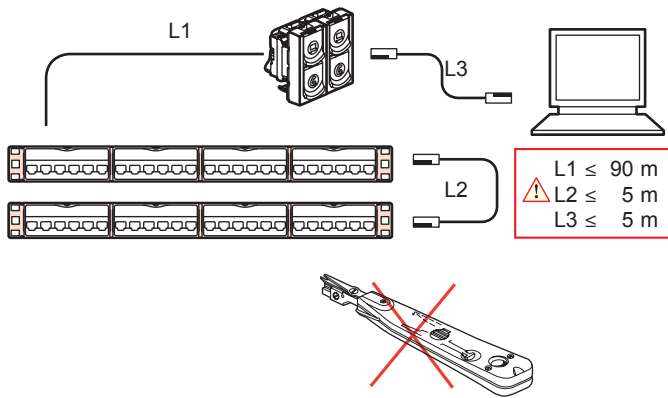

6. OVERALL DIMENSIONS

Front view:

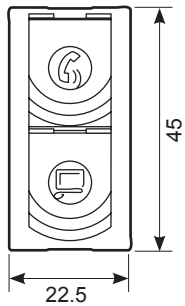

Side view:

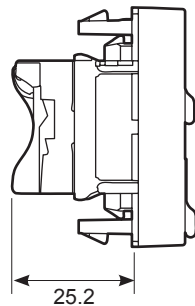

7. CONNECTION

The following connections are to be respected according to the type of double socket:

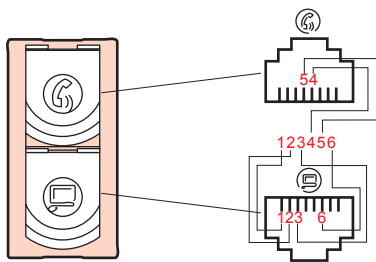

7. CONNECTION

Accepts the following cable connectors:
RJ11 (4 contacts), RJ12 (6 contacts), RJ45 (9 contacts).

Double colour code EIA – TIA 568 A and B on terminals:

- UTP 8 contacts
- FTP 9 contacts

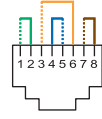

EIA 568 A

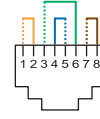

EIA 568 B

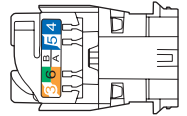
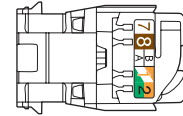

Conductors supported:

- Single-strand: 0.5 to 0.65 mm, AWG 22 to 24
- Multi-strand: AWG 26 to 27
- Polyethylene conductor insulation: max. Ø with insulation 1.58 mm

Number of wires to connect per connection: 1

The RJ45 connectors are equipped with a rotating locking system that does not require special tools and enables rewiring in the event of error.

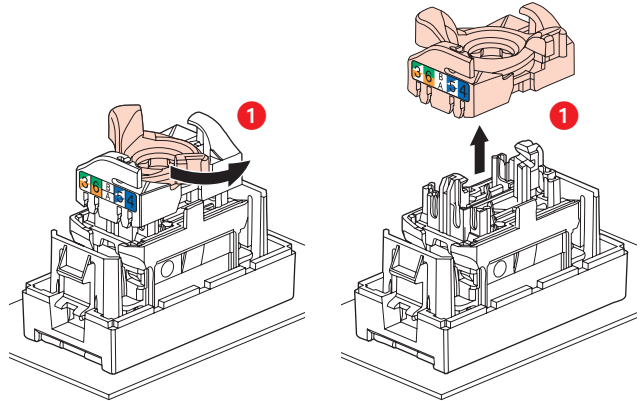

This system allows the wire pairs to be spread easily before attaching them to the connector.

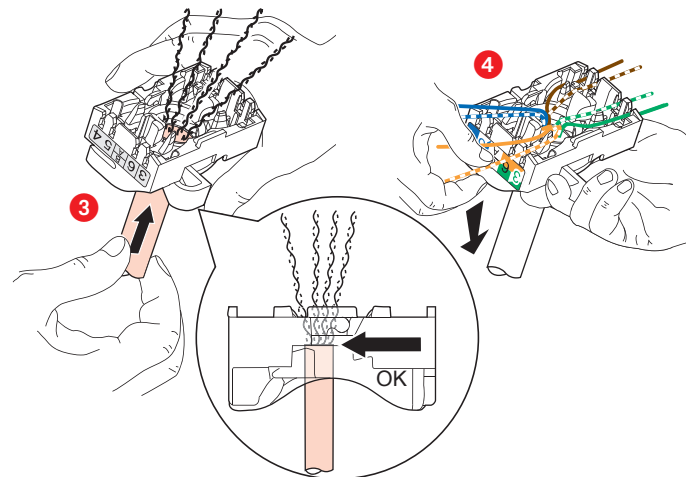

Spreading the wires ensures that pairs are separated by the required 13 mm.

Spreading the pairs at 90° in relation to the cable ensures the best performance levels.

8. STANDARDS AND APPROVALS

Connector tested and guaranteed to support POE signals, standard IEEE 802.3af and POE+, draft standards 802.3at, up to 2500 connections and disconnections with load.

Tests are carried out with 2 simultaneous POE+ circuits producing a minimum total power of 50W.

RoHS compatible.