

AVD370

LED | TC | E27



AVD370 is beautiful plafond luminaire for general lighting both at home and in public premises. It can be used as universal luminaire at home as well as sensor luminaire in office buildings at corridors and staircases.

Move!

Ensto Luminaires and movement detection is a base for many Smart Solutions but operate perfectly as a standalone versions as well. Ensto Move!-luminaires use PIR or Radar technique, depending on your projects and demand.

DALI

DALI drivers enable luminaires to be connected to DALI based control systems and Smart Buildings. Compared to a fixed output installation, the dimming and individual control capability provided by DALI enables considerable energy savings and control, depending on luminaire specifications.

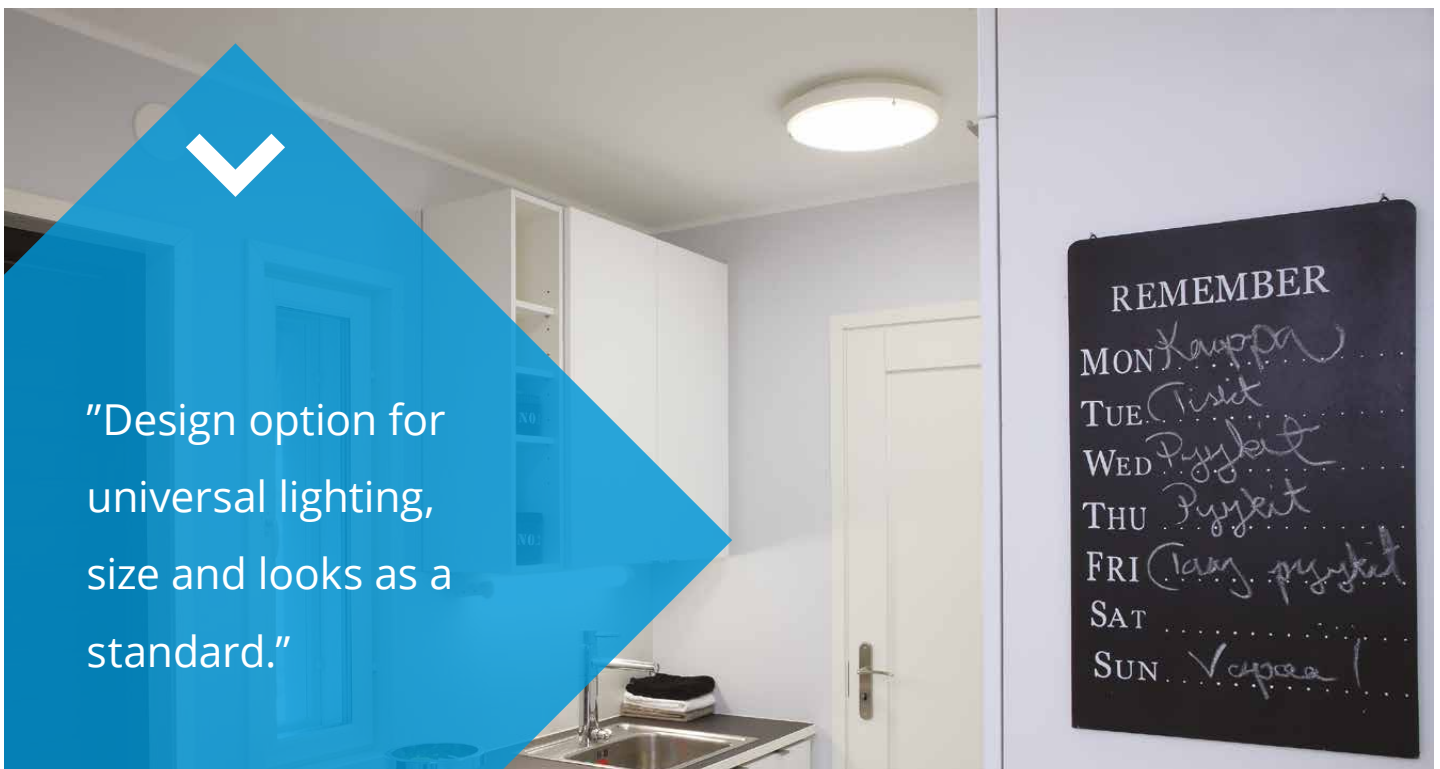

“Design option for universal lighting, size and looks as a standard.”

REMEMBER
 MON *Kaoppa*
 TUE *Tivist*
 WED *Pyykit*
 THU *Pyykit*
 FRI *laay. pyykit*
 SAT
 SUN *Vapaa!*



AVD370 PIR sensor luminaire

Structure

- › Diffuser opal polycarbonate or glass
- › Body aluminium
- › Colour temperature 3000 K/4000 K
- › LED-models:
connected load
14W, luminaire luminous flux 1468 lm (3000 K),
1516 lm (4000 K),
18W, luminaire luminous flux 1842 lm (3000 K),
1902 lm (4000 K),
3000/4000 K, Ra > 80, power factor 0,9
Ambient temperature - 20 °C - + 25 °C
LED-module lifespan 70 000 h (L70), T_a=25 °C

Control

- › AVD370 PIR-type of luminaires are sensor luminaires equipped with infra-red motion sensor (PIR) in which are settings for time (1-30 min.), sensitivity and twilight switch function
- › AVD370 RADAR-type of luminaires are sensor luminaires equipped with high-frequency radar to detect motion (Radar) in which are settings for time (1-30 min.), sensitivity and twilight switch function
- › 1-10V
- › DALI
- › Switch-control

Mounting

- › To the ceiling and to the wall or partly recessed
- › Recess depth 28 mm, recess hole ø 315 mm, diffuser diameter ø 370 mm
- › Snap-in terminal block 5x2,5 mm² with through wiring, PIR-/RADAR-models -o- 5x2,5 mm² + 2x2,5 mm²
- › Sensor luminaire models see more accurate information at WEB-site
- PIR-models:
To the ceiling max. 4 meters height
To the wall max. 1,7-2,7 meters height
- RADAR-models:
To the ceiling max. 3,5 meters height
To the wall 1,7- 2,7 meters height
- Suitable for stand-alone and master-slave installation
- Maximum load behind one master is 400VA, however max. 5 luminaires in the same control group
- Slave luminaires from the Ensto basic luminaire range

E number	Type	Product name	Base	Kg	Luminous flux
AVD370 LED basic luminaires					
41 172 41	AVD370.114L	AVD370 IP44 LED14W/840 E	LED	1,2	1516 lm
41 172 59	AVD370.114L/3K	AVD370 IP44 LED14W/830 E	LED	1,2	1468 lm
41 595 08	AVD370.118L	AVD370 IP44 LED 18W/840 E PC O	LED	1,2	1902 lm
41 595 20	AVD370.118L/3K	AVD370 IP44 LED 18W/830 E PC O	LED	1,2	1842 lm
AVD370 LED basic luminaires with glass diffuser					
41 172 42	AVD370.114LG	AVD370 IP21/44 LED14W/840 EG	LED	1,7	1366 lm
41 172 60	AVD370.114LG/3K	AVD370 IP21/44 LED14W/840 EG	LED	1,7	1322 lm
41 595 09	AVD370.118LG	AVD370 IP21/44 LED 18W/840 E G FR	LED	1,7	1705 lm
41 595 21	AVD370.118LG/3K	AVD370 IP21/44 LED 18W/830 E G FR	LED	1,7	1651 lm
AVD370 LED basic luminaires with 1-10V controlled electronic control gear					
41 172 48	AVD370.114DL	AVD370 IP44 LED14W/840 D	LED	1,2	1516 lm
41 172 65	AVD370.114DL/3K	AVD370 IP44 LED14W/830 D	LED	1,2	1468 lm
41 595 13	AVD370.118DL	AVD370 IP44 LED 18W/840 D PC O	LED	1,2	1902 lm
41 595 24	AVD370.118DL/3K	AVD370 IP44 LED 18W/830 D PC O	LED	1,2	1842 lm



E number	Type	Product name	Base	Kg	Luminous flux
AVD370 LED basic luminaires with 1-10V controlled electronic control gear and glass diffuser					
41 172 50	AVD370.114DLG	AVD370 IP21/44 LED14W/840 DG	LED	1,7	1366 lm
41 172 66	AVD370.114DLG/3K	AVD370 IP21/44 LED14W/830 DG	LED	1,7	1322 lm
41 595 14	AVD370.118DLG	AVD370 IP21/44 LED 18W/840 D G FR	LED	1,7	1705 lm
41 595 25	AVD370.118DLG/3K	AVD370 IP21/44 LED 18W/830 D G FR	LED	1,7	1651 lm
AVD370 LED basic luminaires with DALI control gear					
41 172 56	AVD370.114DDL	AVD370 IP44 LED14W/840 DALI	LED	1,2	1516 lm
41 172 75	AVD370.114DDL/3K	AVD370 IP44 LED14W/830 DALI	LED	1,2	1468 lm
41 595 18	AVD370.118DDL	AVD370 IP44 LED 18W/840 DALI PC O	LED	1,2	1902 lm
41 595 28	AVD370.118DDL/3K	AVD370 IP44 LED 18W/830 DALI PC O	LED	1,2	1842 lm
AVD370 LED basic luminaires with DALI control gear and with glass diffuser					
41 172 57	AVD370.114DDL	AVD370 IP21/44 LED14W/840DALIG	LED	1,7	1366 lm
41 172 89	AVD370.114DDL/3K	AVD370 IP21/44 LED14W/830DALIG	LED	1,7	1322 lm
41 595 19	AVD370.118DDL	AVD370 IP21/44 LED 18W/840 DALI GFR	LED	1,7	1705 lm
41 595 29	AVD370.118DDL/3K	AVD370 IP21/44 LED 18W/830 DALI GFR	LED	1,7	1651 lm
AVD370 LED basic sensor luminaires					
41 172 44	AVD370.1144L	AVD370 IP44 LED14W/840 EPIR	LED	1,2	1516 lm
41 172 62	AVD370.1144L/3K	AVD370 IP44 LED14W/830 EPIR	LED	1,2	1468 lm
41 595 10	AVD370.1184L	AVD370 IP44 LED 18W/840 E PC O PIR	LED	1,2	1902 lm
41 595 22	AVD370.1184L/3K	AVD370 IP44 LED 18W/830 E PC O PIR	LED	1,2	1842 lm
AVD370 LED basic sensor luminaires with glass diffuser					
41 172 45	AVD370.1149LG	AVD370 IP21/44 LED14W/840EGRAD	LED	1,9	1366 lm
41 172 63	AVD370.1149LG/3K	AVD370 IP21/44 LED14W/830EGRAD	LED	1,9	1322 lm
41 595 11	AVD370.1189LG	AVD370 IP21/44 LED 18W/840 EGFR RAD	LED	1,9	1705 lm
41 595 23	AVD370.1189LG/3K	AVD370 IP21/44 LED 18W/830 EGFR RAD	LED	1,9	1651 lm
AVD370 LED PIR sensor luminaires with 1-10V dimmable electronic control gear. Base light level 5% or 20% and PIR controlled light level 80% or 100%					
41 172 51	AVD370.1145DL	AVD370 IP44 LED14W/840 DPIR5	LED	1,2	1516 lm
41 172 68	AVD370.1145DL/3K	AVD370 IP44 LED14W/830 DPIR5	LED	1,2	1468 lm
41 595 15	AVD370.1185DL	AVD370 IP44 LED 18W/840 D PC O PIR	LED	1,2	1902 lm
41 595 26	AVD370.1185DL/3K	AVD370 IP44 LED 18W/830 D PC O PIR	LED	1,2	1842 lm
AVD370 LED radar sensor luminaire with 1-10V dimmable electronic control gear and with glass diffuser. Base light level 5% and radar controlled light level 100%					
41 172 53	AVD370.1149DLG	AVD370 IP21/44 LED14W/840DGRAD	LED	1,9	1366 lm
41 172 69	AVD370.1149DLG/3K	AVD370 IP21/44 LED14W/830DGRAD	LED	1,9	1322 lm
41 595 16	AVD370.1189DLG	AVD370 IP21/44 LED 18W/840 DGFR RAD	LED	1,9	1705 lm
41 595 27	AVD370.1189DLG/3K	AVD370 IP21/44 LED 18W/830 EGFR RAD	LED	1,9	1651 lm
AVD 370 LED basic luminaire with 1 hour battery back-up					
41 172 47	AVD370.114L/1M	AVD370 IP44 LED14W/840 E1M	LED	1,6	1516 lm
41 595 12	AVD370.118L/1M	AVD370/1M IP44 LED 18W/840 E PC O	LED	1,6	1902 lm
AVD370 LED PIR sensor luminaires with 1-10V dimmable electronic control gear. Base light level 5% or 20% and PIR controlled light level 80% or 100%, 1 hour battery back-up.					
41 172 54	AVD370.1145DL/1M	AVD370 IP44 LED14W/840 DPIR51M	LED	1,6	1516 lm
41 595 17	AVD370.1185DL/1M	AVD370/1M IP44 LED 18W/840 D PC O P	LED	1,6	1902 lm
AVD370 luminaires with plastic diffuser and E27					
41 170 79	AVD370	AVD370 IP44 2xTC-TSE 20W PC O	E27	0,9	
AVD370 luminaires with glass diffuser and E27					
41 172 09	AVD370.01PE27G	AVD370 IP21/44 1xTC-TSE 20W G FR	E27	1,6	
41 172 12	AVD370.02PE27G	AVD370 IP21/44 2xTC-TSE 20W G FR	E27	1,7	

E number	Type	Product name	Base	Kg	Luminous flux
AVD370 luminaires with electronic control gear					
41 171 00	AVD370.218E	AVD370 IP44 2xTC-DE 18W E PC O	G24-q2	1,2	
41 171 06	AVD370.226E	AVD370 IP44 2xTC-DE 26W E PC O	G24-q3	1,2	
AVD370 accessories					
41 171 12	AVL370	AVD370 recessed mounting fastening			
41 171 13	AVL372	Flush mounting frame for AVR320/AVD370 luminaires, 600 mm x 600 mm			

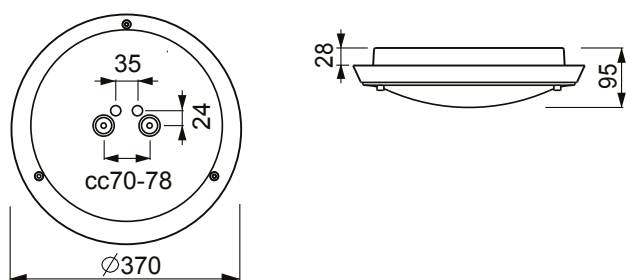

AVD370

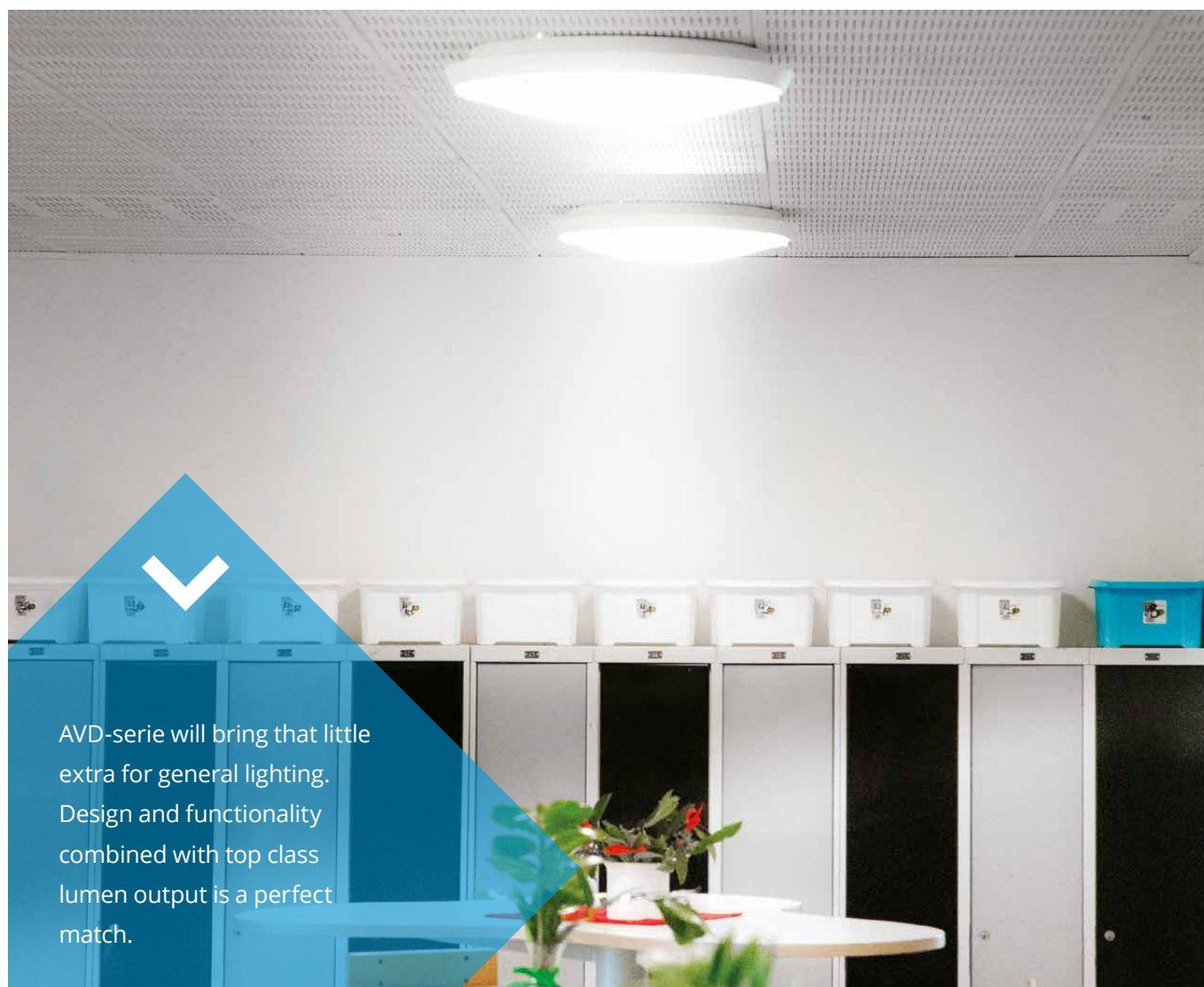

AVD-serie will bring that little extra for general lighting. Design and functionality combined with top class lumen output is a perfect match.