

- Hublots
  - Wandlicht
  - Bulkhead
  - Leuchte
- 620 XX - 621 XX

- Hublots
- Fanale
- مصباح على شكل كوة



- Caractéristiques
- Gegevens

NFC 71 000 (EN 60598)



IP 54  
IP 55



E27

- Features
- Technische Daten

Ø 340 \* E27 - 100 W maxi



G23 - 2 x 11 W - 230V/240V 50Hz  
GR10 - 2D 21 W - 230V/240V 50Hz  
GR10 - 2D 28 W - 230V/240V 50Hz  
GR10 - 2D 38 W - 230V/240V 50Hz

Ø 296



\* E27 - 75 W maxi

G23 - 2 x 9 W - 230V/240V 50Hz  
GR8 - 2D 16 W - 230V/240V 50Hz  
GR10 - 2D 21 W - 230V/240V 50Hz

Ø 296



E27 - 60 W maxi

G23 - 2 x 9 W - 230V/240V 50Hz  
GR8 - 2D 16 W - 230V/240V 50Hz  
GR10 - 2D 21 W - 230V/240V 50Hz

- الخصائص

- Démontage
- Demontage

- Removal
- Ausbau

- Desmontaje
- Smontaggio

- الفك

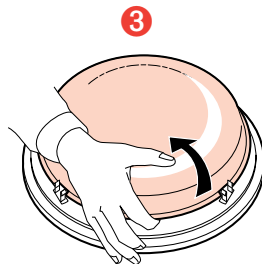
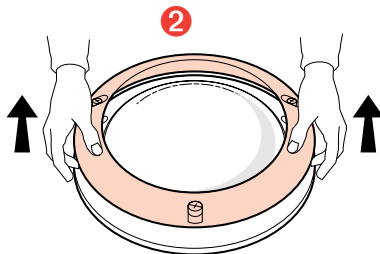
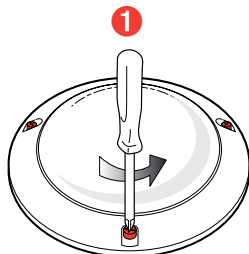

- Possibilités de fixation
- Bevestigingsmogelijkheden
- Possible attachments

- Befestigungsmöglichkeiten
- Posibilidades de fijación
- Possibilità di fissaggio

- التثبيتات الممكنة

\*E27 - 60W, 75W

Ø 296

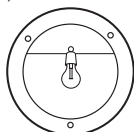
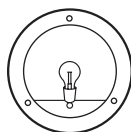

Ø 340

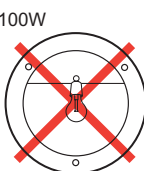
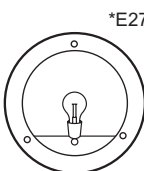
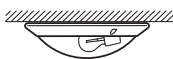

\*E27 - 100W

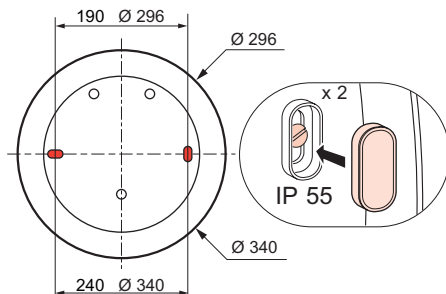

• Raccordement  
• Aansluiting

• Connection  
• Anschluß

• Conexión  
• Collegamento

• التوصيل

- Pour ampoule opalisée de préférence
- Bij voorkeur voor geopaliseerde lampen
- Preferably for internally coated bulb
- vorzugsweise bei matter Glühbirne

- Para Lámpara opal preferentemente
- Per lampadina opalizzata preferibilmente
- يناسب بشكل أفضل لمبة مكسوة داخليا

Class. II  E27

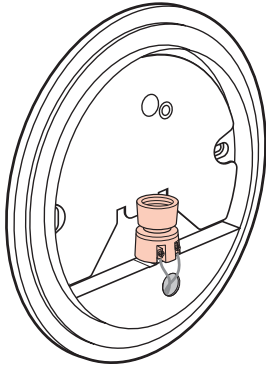

1

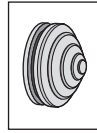

Ø 5 min.  
16 max.

E27 : 50 mm  
(110 mm maxi)

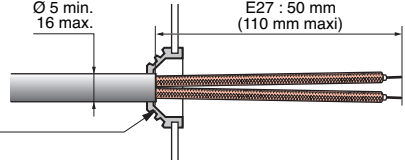

E 27

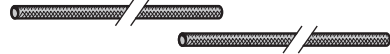

- Attention : Gains de protections thermiques obligatoire
- Opgelet : Verplicht toe te passen thermische veiligheidsomhulsels
- Caution : Thermal protection sheaths, required
- Achtung : Wärmeschutzhüllen vorgeschrieben
- Atención : Funda de protección térmica obligatoria
- Attenzione : Guaine di protezione termica obbligatorie
- تنبيه: أغمدة الحماية ضد الحرارة إجبارية

Class. I G23, GR10, GR8

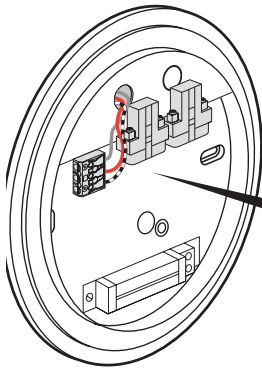

1

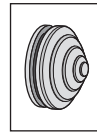

Ø 5 min.  
16 max.

100 mm

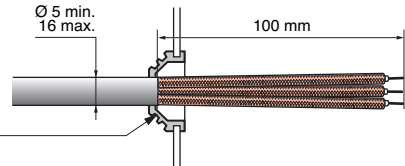

2

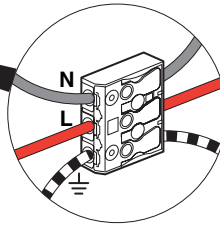

• Remontage  
• Montage

• Reinstallation  
• Wiedereinbau

• Montaje  
• Montaggio

• إعادة التركيب

1

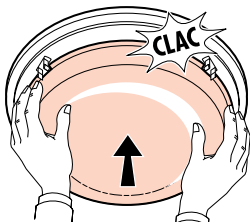

2

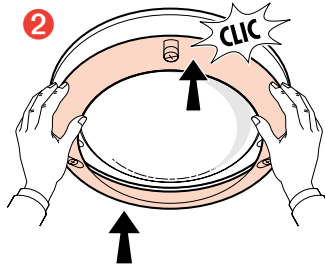

3

